

W - SERIES

Features and advantages.

Multi stage high precision gearbox with extremely large hollow shaft
Tapered roller bearing or angular ball bearing integrated directly in the gearbox housing.
Very large hole for easy laying of cables or similar.

Important features

- Zero mechanical backlash / 1 arcmin Lost Motion
- 2 sizes
- Reduction ratios 1:64 (size W55) and 1:87 (size W70)
- Acceleration torque up to 10000 Nm
- Output speed up to 30 rpm
- Torsional stiffness up to 1960 Nm / arcmin
- Motor connection with coupling on request
- Motor adapter on request



get insights



Main dimensions and weight

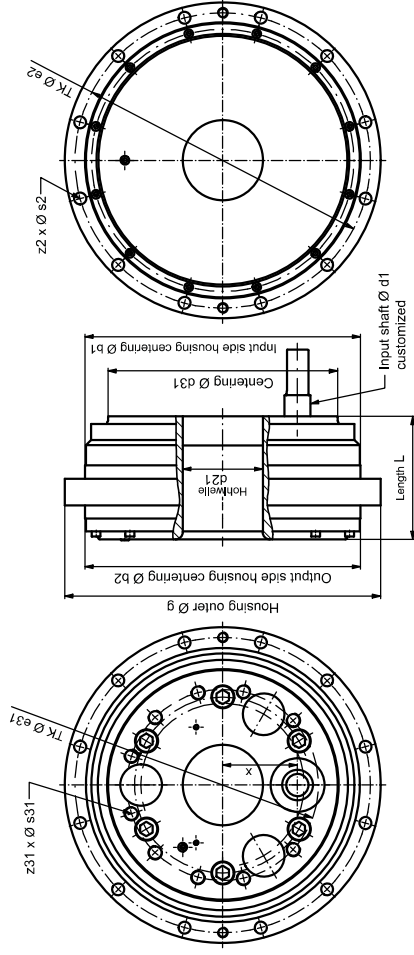

	L	$\varnothing g$	$\varnothing b2$	$h7$	$\varnothing e2$	$z2$	$\varnothing s2$	$\varnothing b1$	$h8$	$\varnothing d31$	$h7$	$z31$	$\varnothing s31$	$\varnothing d21$	WEIGHT
SIZE	[mm]	[mm]	[mm]	[mm]	[mm]	[mm]	[mm]	[mm]	[mm]	[mm]	[mm]	[mm]	Thread	[mm]	[kg]
W55	138	355	310	310	332	12	13.5	310	310	258	215	10	M16	90	65
W70	192.5	470	383	383	447	16	13	425	390	358	358	15	M16	138	95

Main data torque & speed

SIZE	NOMINAL OUTPUT TORQUE (1) [NM]	ACCELERATION / BRAKE TORQUE [NM]	MAX OUTPUT SPEED [RPM]
W55	2453	6130	30
W70	4000	10000	25

(1) at output speed $n2=15$ rpm

The above technical data is intended to enable a rough pre-selection only.

Output bearing capacity

SIZE	MAX. PERMISSIBLE BENDING MOMENT [NM]	MAX. PERMISSIBLE AXIAL LOAD PUSH / PULL [N]
W55	9565	13734
W70	22000	29400

Available ratios

SIZE	RATIOS
W55	64
W70	87.3

Other ratios depending on the prestige
24 | 25 Sumitomo Drive Technologies